



2
BEDROOMS



1
BATHROOM

Balgonie

The Balgonie is a delightful 2 bedroom detached bungalow with a spacious open plan kitchen/lounge. This is further complemented by a separate utility room. It has a well-appointed bathroom which includes a quadrant shower enclosure and separate bath. Both bedrooms benefit from fitted wardrobes. Further ample storage is provided for in both the utility room and hallway cupboards.





Kings Meadow

Coaltown Of Balgonie

Balgonie

2 Bedroom Detached Bungalow

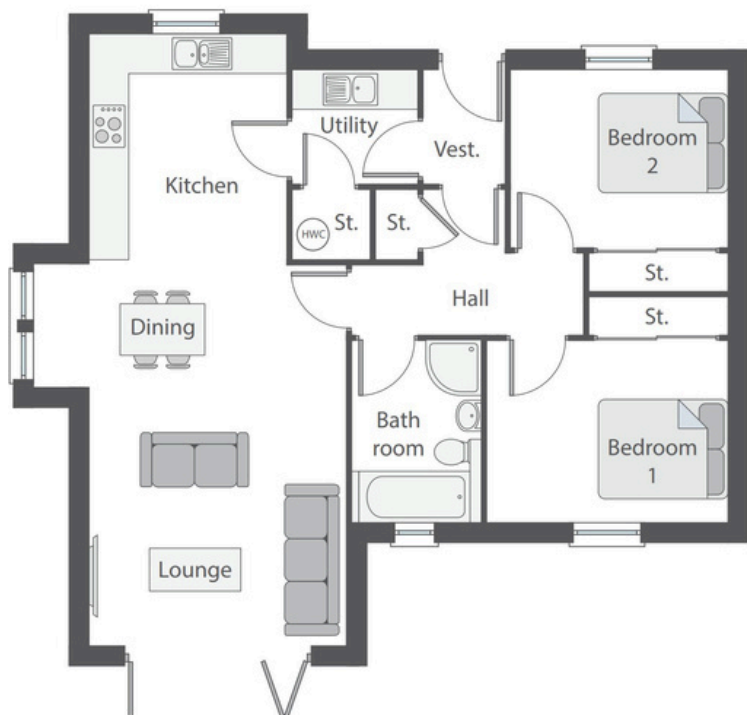

Room	Width (Metric)	Depth (Metric)	Width (Imperial)	Depth (Imperial)
Vestibule	1280	1830	4' - 2"	6' - 0"
Hall	3676	2270	12' - 1"	7' - 5"
Bathroom	2020	2895	6' - 8"	9' - 6"
Utility	2027	1830	6' - 8"	6' - 0"
Kitchen / Dining	3164	5658	10' - 5"	18' - 7"
Lounge	4164	4177	13' - 8"	13' - 8"
Bedroom 1	3876	2895	12' - 9"	9' - 6"
Bedroom 2	3496	2831	11' - 5"	9' - 3"

All quoted room sizes are approximate structural dimensions and may vary due to normal building tolerances. CGI's are for guidance only.



EASY LIVING

HOMES

Unit 17, Eastfield BusinessPark, Newark Road South, Glenrothes, Fife KY7 4NS
Phone: 01592 770020 | Email: info@easylivinghomes.co.uk
www.easylivinghomes.co.uk